

**IMPORTANT** - READ CAREFULLY BEFORE INSTALLING FIXTURE. RETAIN THESE INSTRUCTIONS FOR FUTURE REFERENCE. THIS PRODUCT MUST BE INSTALLED IN ACCORDANCE WITH THE NATIONAL ELECTRICAL CODE AND ALL APPLICABLE LOCAL CODES, BY A PERSON FAMILIAR WITH THE CONSTRUCTION AND OPERATION OF THE PRODUCT, AND THE HAZARDS INVOLVED. PROPER GROUNDING IS REQUIRED FOR SAFETY.

**⚠ DISCONNECT THE MAIN LINE BEFORE WIRING SECONDARY CONNECTORS.**

## IN-LINE UNIT INSTALLATION

**INTEGRAL DRIVER (120 / 277V)**

**DIMMING TRIAC/ELV (15%), 0-10V (1%), LUTRON HI-LUME® (1% EcoSystem™ / 1% 2-WIRE)**

A- PREPARE CEILING WITH ANCHOR SCREWS (SEE ANCHOR DISTANCE ON P.4). **DETAIL 1:**

- 1- PASS SCREW THROUGH THREADED RING AND SECURE SCREW INTO PLASTIC ANCHOR SCREW.
- 2- PASS SUSPENSION CABLE THROUGH MOUNTING COUPLING.
- 3- FASTEN MOUNTING COUPLING TO THREADED RING.

B- FIX SUSPENSION CABLE TO ALUMINUM EXTRUSION (SEE **DETAIL 2** ON P.2).

C- CANOPY INSTALLATION AND JUNCTION BOX WIRING (SEE **DETAIL 3** ON P.3).

**A + B + C**

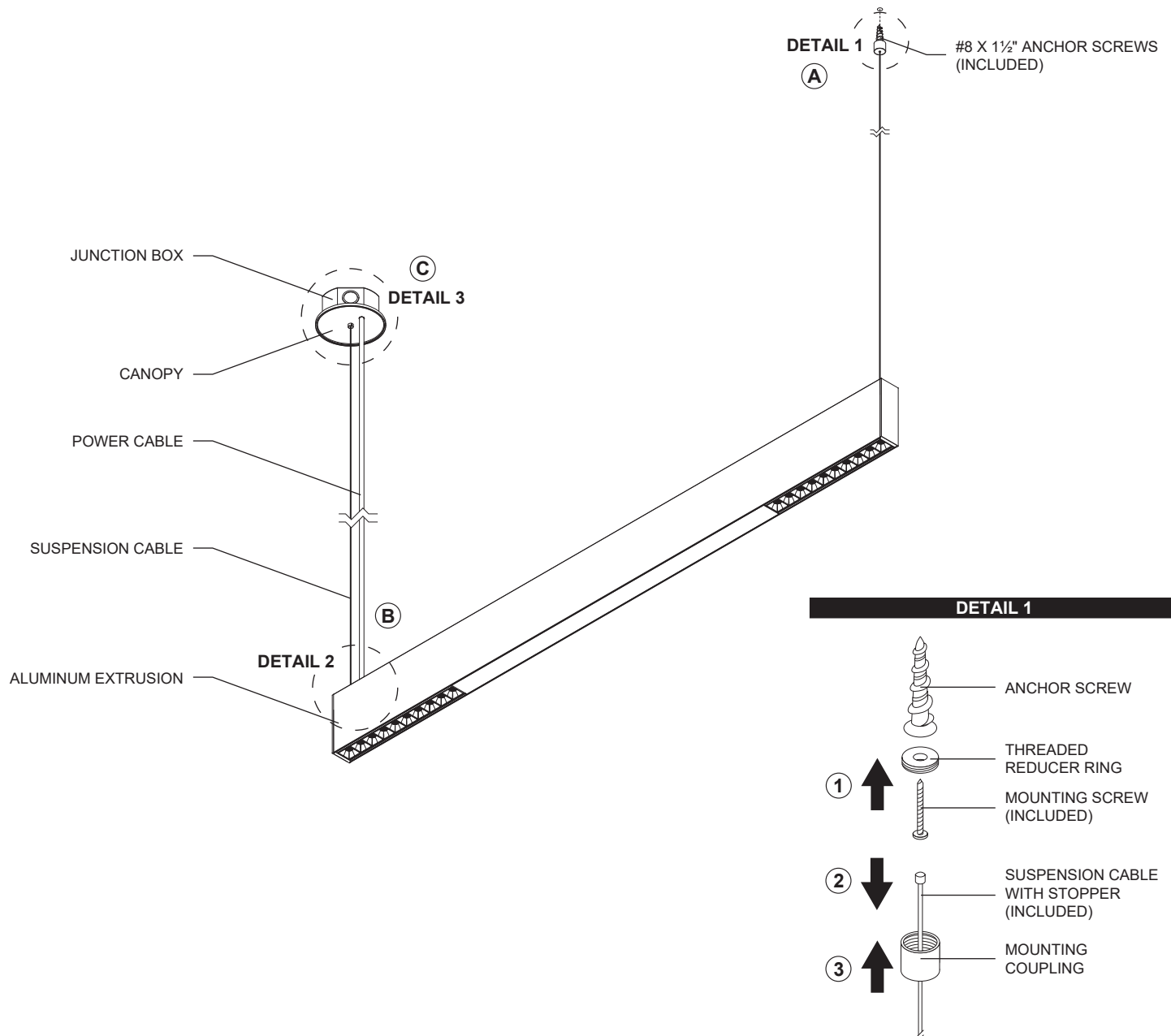

## DETAIL 2 - MECHANICAL ASSEMBLY

- A- REMOVE ALUMINUM U-SHAPE COVER AND DIFFUSER / COVER PLATE (IF NECESSARY).
- B- UNFASTEN CABLE GRIPPER SECURITY NUT TO RELEASE CABLE GRIPPING SYSTEM. DO NOT COMPLETELY REMOVE THE SCREW.
- C- LIFT THE FIXTURE TO THE SUSPENSION CABLE AND INSERT THE SUSPENSION CABLE THROUGH THE CABLE GRIPPER.
- D- SET THE UNIT TO THE APPROPRIATE HEIGHT AND FASTEN THE CABLE GRIPPER.
- E- CUT THE EXCESS SUSPENSION CABLE END.
- F- SNAP THE COVER PLATE / DIFFUSER AND THE U-SHAPE COVER BACK ON THE ALUMINUM EXTRUSION. BOTH SUSPENSION CABLE AND POWER CABLE MUST GO THROUGH U-TYPE OPENING.

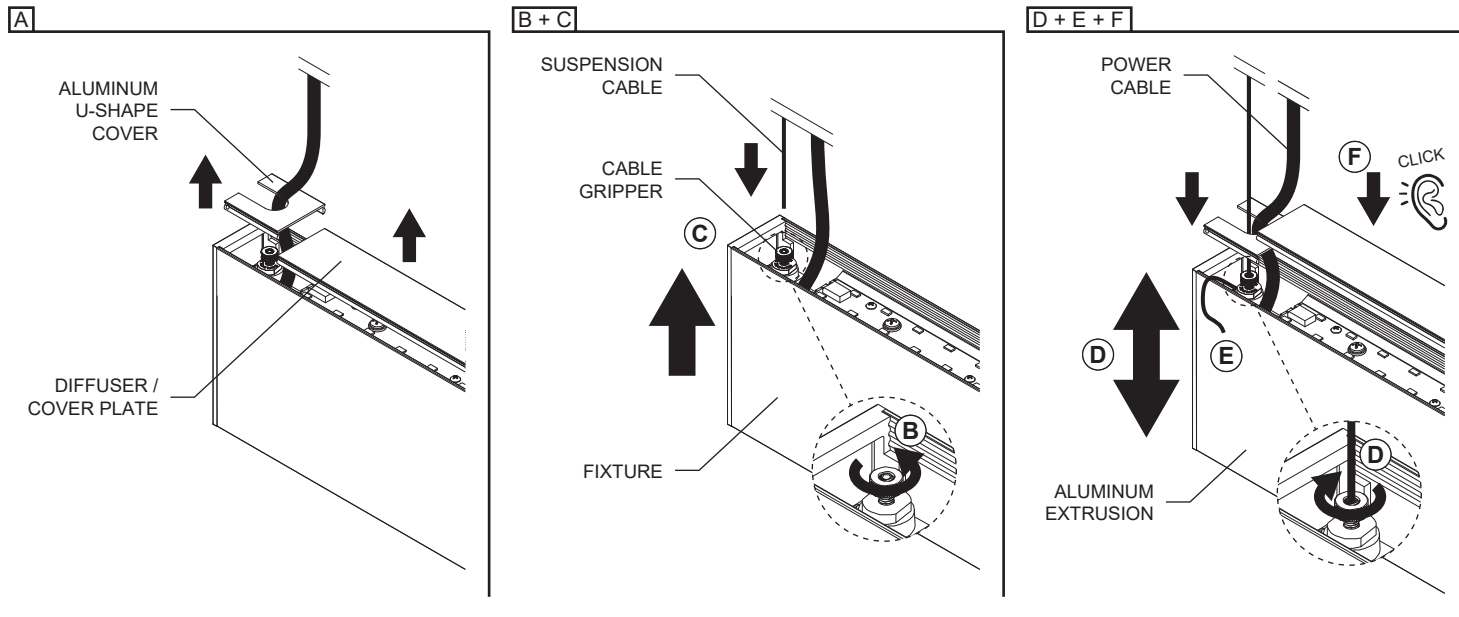

**DETAIL 3 - CANOPY INSTALLATION**

- A- RUN THE POWER CABLE THROUGH THE CANOPY AND THROUGH THE MOUNTING CROSSBAR HOLE. ADJUST THE CABLE LENGTH AND SECURE IT USING THE CABLE GRIPPER TO LOCK IT'S POSITION AGAINST THE MOUNTING CROSSBAR.
- B- MAKE NECESSARY WIRE CONNECTIONS (**SEE WIRING DIAGRAM**) USING TWIST CONNECTORS (**NOT INCLUDED**).  
FOR DIMMING 0-10V: WIRES MUST BE RUN THROUGH A SEPARATE KNOCKOUT HOLE WHEN CONNECTING DIMMING CONTROLLER.
- C- INSTALL THE MOUNTING CROSSBAR USING (2) PHILLIPS SCREWS (**INCLUDED**).
- D- PASS THE THUMB SCREW INTO THE MOUNTING CROSSBAR KEY HOLE WITH IT'S LOCK WASHER ON TOP. HOLD THE SUSPENSION CABLE DOWN AT THE DESIRED POSITION AND SECURE WITH THE PROVIDED NUT.
- E- SECURE THE CANOPY BY SCREWING THE CANOPY'S FINISHING SCREW ON THE MOUNTING CROSSBAR'S THUMB SCREW.

**A + B + C + D + E**

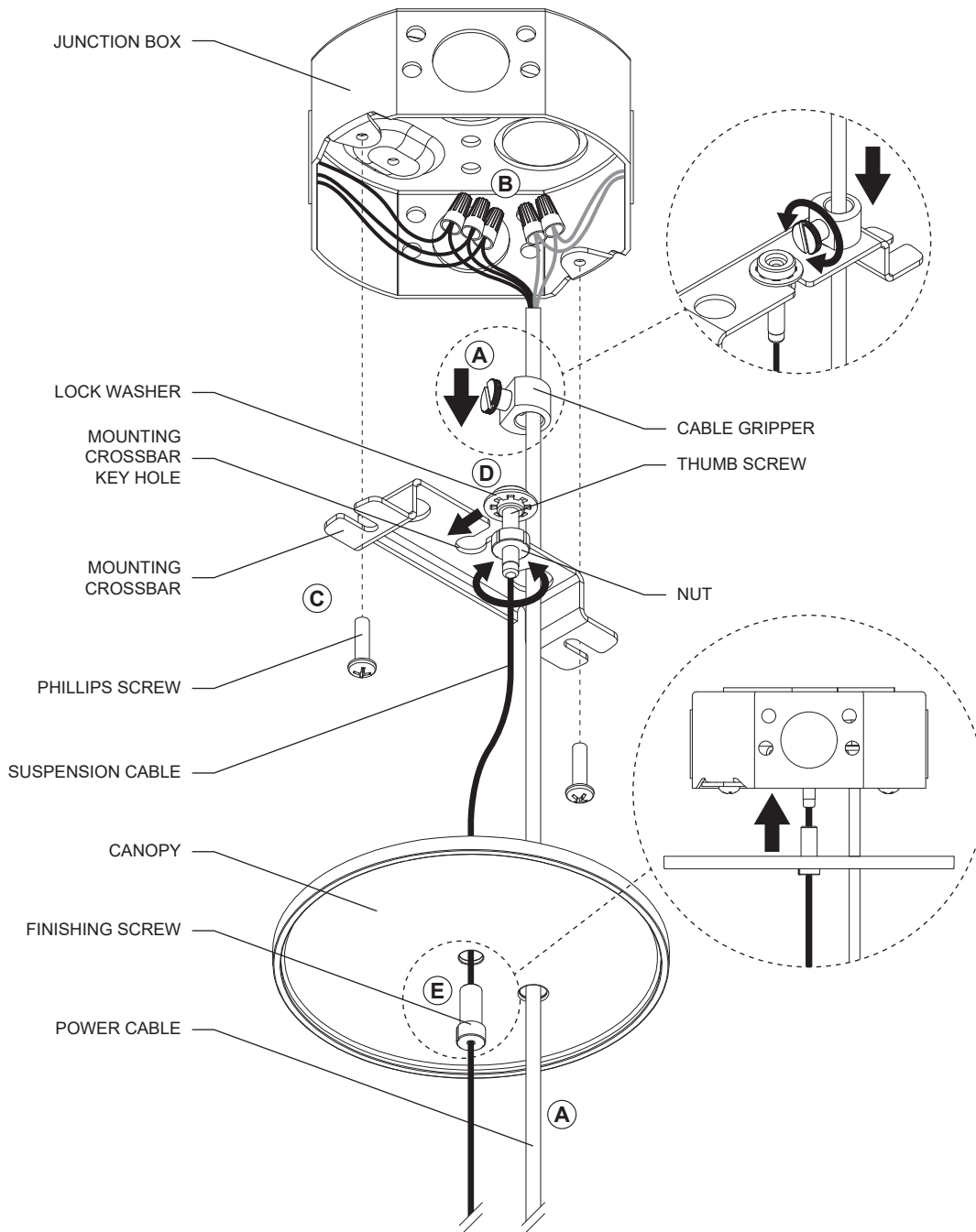

**WIRING DIAGRAM\***

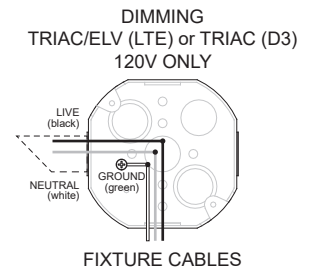
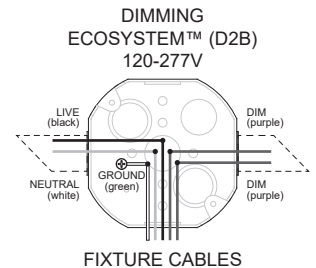
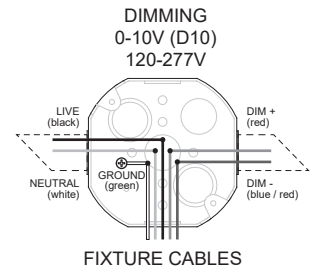

\*for reference only

PENDANT ANCHOR POINTS DISTANCE

SOLO UNIT 4'

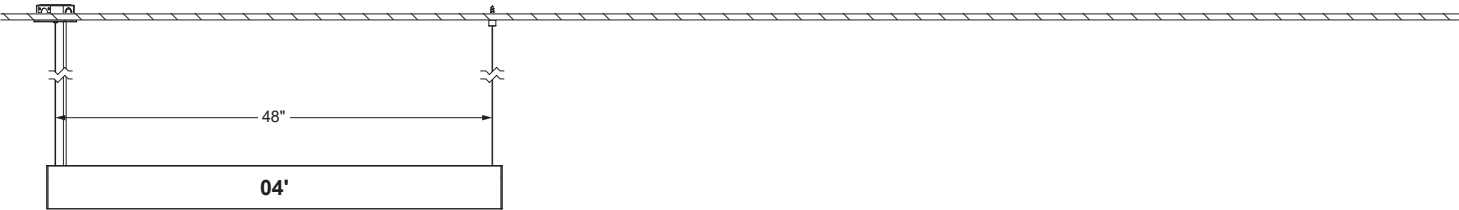

SOLO UNIT 8'

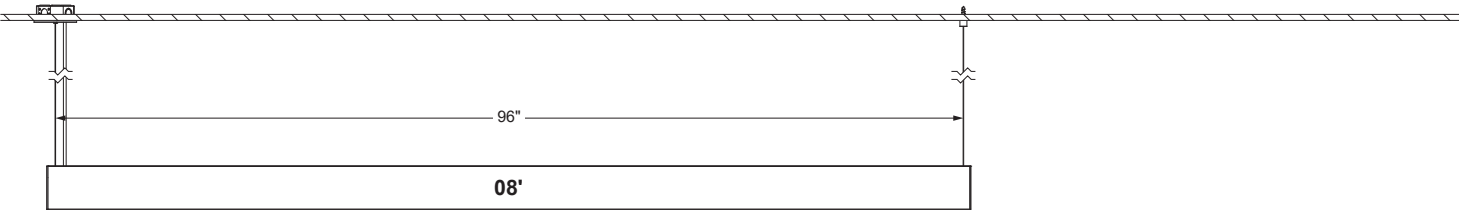

ANCHOR POINTS FOR LINEAR PENDANT ALL CONFIGURATIONS		
Nominal length	Actual length	Anchor distance
04'	4'-1 $\frac{1}{8}$ " (1.265m)	48" (1.219m)
08'	8'-1 $\frac{1}{8}$ " (2.484m)	96" (2.438m)